



**41<sup>st</sup> Annual Meeting**  
**of the**  
**New England Educational Research Organization**

**Conference Program**  
**May 6-8, 2009**

**Sheraton Portsmouth Harborside Hotel**  
**250 Market Street**  
**Portsmouth, NH 03801**

## **New England Educational Research Organization: May 2009**

The New England Educational Research Organization is a regional research organization with approximately 200 members from colleges and universities, public and private schools, state and local educational agencies, health and social service agencies, and private education firms.

### **NEERO's primary objectives are:**

- Improve educational programs and supervisory practices
- Provide a stimulating, supportive and friendly forum for scholarly presentations
- Identify and disseminate successful educational practices
- Foster skill development in research and evaluation methodologies

We pursue these objectives through a variety of activities and events, the most major of which is our annual research conference.

### **Mission**

The mission of the New England Educational Research Organization shall be to promote, improve, and disseminate information about all forms of educational research, thereby continuing to increase the contribution of education to human welfare.

## NEERO Presidents

- 1969-1971 John Schmidt, Boston College  
1971-1972 Edward Pepyne, University of Hartford  
1972-1973 Anne Marie Bernazza HaaseAn, University of Massachusetts  
1973-1974 Joyce W. Lancaster, Emerson College  
1974-1975 Gary E. Kasey, University of Connecticut  
1975-976 Mervyn D. Lynch, Northeastern  
1976-1977 Marvin G. Cline, Research Institute for Educational Problems  
1977-1978 Donald T. Donley, Boston College  
1978-1979 Janet Burke, University of Lowell  
1979-1980 Charles F. Smith, University of Southern Maine  
1980-1981 Pasquale DeVito, Rhode Island Department of Education  
1981-1982 Reuben R. Rusch, State University of New York at Albany  
1982-1983 Theodore R. Cromack, Virginia Polytechnic Institute & University at Dulles  
1983-1984 David L. Silvermail, University of Southern Maine  
1984-1985 Stephanie R. Blecharczyk, Keene State College  
1985-1986 Kay Coleman, Boston University  
1986-1987 Richard L. Egelston, New York State Education Department  
1987-1988 Libby G. Cohen, University of Southern Maine  
1988-1989 Ronald L. Nuttall, Boston College  
1989-1990 Larry H. Ludlow, Boston College  
1990-1991 Margaret J. Simon, RMC Research Corporation  
1991-1992 Carol Lynn Davis, University of Southern Maine  
1992-1993 Beverly Ferrucci, Keene State College  
1993-1994 Constance M. Perry, University of Maine  
1994-1995 Eiki Satake, Emerson College  
1995-1996 Susan Vernon-Gesterfelt, Worcester Polytechnic Institute  
1996-1997 Marshall Strax, College of Saint Elizabeth  
1997-1998 Carol Strax, Fordham University  
1998-2000 Grant Cioffi & Thomas Schram, University of New Hampshire  
2000-2002 Charles DePascale, Massachusetts Department of Education  
2002-2004 Susan Etheridge, Smith College  
2004-2006 Casey Cobb, University of Connecticut  
2006-2008 Kim Fries, University of New Hampshire  
2008-2010 Patricia Paugh, University of Massachusetts

**BOARD OF DIRECTORS, 2009**

**OFFICERS**

PATRICIA PAUGH  
President,  
University of Massachusetts, Boston

JORGELINA ABBATE-VAUGHN  
Vice-President and Treasurer,  
University of Massachusetts, Boston

CHRISTA WINTER \*  
Secretary,  
Springfield College

KIM FRIES  
Past President,  
University of New Hampshire

**REGIONAL REPRESENTATIVES**

**PROJECT DIRECTORS**

LUSA LO, Massachusetts  
University of Massachusetts Boston

KATHY MIRAGLIA, Conference \*  
University of Massachusetts-Dartmouth

SALLY MACKENZIE, Maine \*  
University of Maine

CHARLES DEPASCALE, Membership  
Center for Assessment

JULIE SIMPSON, New Hampshire  
University of New Hampshire

LARRY LUDLOW, Historian  
Boston College

MICHAEL L. HOCK, Vermont  
Vermont Department of Education

DEB PATTERSON, Special Projects  
Western New England College

STEVE STEMLER, Connecticut  
Wesleyan University

CASEY D. COBB, Website Director  
University of Connecticut

FRANK CORBETT, JR., Outside Northeast  
Indiana University of Pennsylvania

DAVID W. KRITT, New York  
College of Staten Island

JENNIFER S. COOK, Rhode Island  
Rhode Island College

**GRADUATE ASSISTANT TO THE BOARD**

2008 - 2009  
MANJARI TULSHAN  
University of Massachusetts, Boston

## REVIEWERS

The organizers of this year's conference would like to acknowledge and thank our colleagues who graciously reviewed the proposals submitted for the 2009 conference. Without their generosity, this conference would not be possible:

### **Reviewers**

Albert, Susan- University of San Francisco  
Ball, Heather- University of Maine  
Barcalow, Emmett - Western New England College  
Belmont, Sarita - American International College  
Betebenner, Damian- Center for Assessment  
Bieger, George- Indiana University of Pennsylvania  
Bray, Paige - The Teachers' Loft \*  
Cobb, Marina- University of San Francisco  
Cook, Jennifer S. -Rhode Island College  
Dean, Cindy- University of Maine \*  
Della Mattered, Julie - University of Maine  
DeGennaro, Donna- University of Massachusetts - Boston  
DePascale, Charlie- Center For Assessment \*  
Dunn, Jennifer- Measured Progress  
Eliot, Michael- University of San Francisco  
Etheredge, Susan- Smith College  
Fello, Sue- Indiana University of Pennsylvania  
Fries, Kim - University of New Hampshire \*  
Gong, Brian-Center for Assessment  
Gracey, Dorothy- Indiana University of Pennsylvania \*  
Helterbran, Valeri- Indiana University of Pennsylvania  
Henning, Gavin- Dartmouth College  
Hock, Michael- Vermont Department of Education  
Jackson, Janna- University of Massachusetts – Boston  
Johnson, Janet- Rhode Island College \*  
Johnson, Rachel - University of New Hampshire  
Kimball, Pam - University of Maine  
Kraus, Rudy- Rhode Island College  
Kress, Tricia- University of Massachusetts \*  
Kritt, David - College of Staten Island- CUNY \*  
Laverick, DeAnna- Indiana University of Pennsylvania  
Leonard, Jack- University of Massachusetts  
Lewandowski, Heidi- Southmoreland School District  
Lo, Lusa- University of Massachusetts \*  
Mackenzie, Sally- University of Maine \*  
McNelly, Tracy- Norwin School District  
Miller, Annie- University of San Francisco

Morrell, Betty- Readfield Elementary School  
Munkatchy, Molly, Western New England College  
Museus, Sam- University of Massachusetts  
Paquette, Kelli Reefer- Indiana University of Pennsylvania  
Patterson, Deb- Western New England College \*  
Ramirez, Andres- Rhode Island College  
Rend, Jill Martin- Indiana University of Pennsylvania  
Ribisi, Stephen-University of Massachusetts \*  
Rieg, Sue- Indiana University of Pennsylvania  
Ross, Wendy-University of Maine  
Samuels, William El- College of Staten Island- CUNY \*  
Shulman, Vivian-College of Staten Island- CUNY  
Smith, Kara-Boston College  
Sobinski-Smith, Mary Jane - Western New England College  
Stemler, Steve - Wesleyan University \*  
Szelenyi, Katalin- University of Massachusetts  
Thistlethwaite, JoAnn- Indiana University of Pennsylvania \*  
Tinnerman, Larry- Indiana State University \*  
Vianna, Eduardo- LaGuardia Community College- CUNY \*  
Wesley, Whitney- Indiana University of Pennsylvania  
Whitt, Dawn- University of San Francisco  
Wright, Brian- University of Massachusetts  
Zalk, Jodie- Massachusetts Department of Education  
Zoino-Jeannetti, Julie - Framingham State College \*

**41<sup>st</sup> ANNUAL CONFERENCE OF THE  
NEW ENGLAND EDUCATIONAL RESEARCH ORGANIZATION  
PORTSMOUTH, MASSACHUSETTS  
MAY 6-8**

**CONFERENCE SCHEDULE**

Wednesday,  
May 6

11:00 a.m.           **Conference Registration Desk Opens**  
Hotel Lobby

11:00 to 5:00 p.m.   Conference Registration

Pre-Conference

12:00 to 2:00 p.m.   Workshop  
*Youth Technology Practices:*  
*New Literacies and Emergent Learning Designs*  
Donna DeGennaro, University of Massachusetts, Boston  
Dana Wilber, University of Massachusetts, Boston  
Gardner Room

2:15 to 4:15 p.m.    Workshop  
*Conducting Research Involving Human Subjects and Navigating the*  
*Institutional Review Board (IRB) Process*  
Julie Simpson, University of New Hampshire  
Lear Room

2:30-3:00 p.m.      Break

7:00 to 9:00 p.m.    Opening Session:  
Rubovits Award Winner  
(Best Paper, NEERO 2008 Conference)  
Sara Young, University of Massachusetts, Amherst  
Harbor's Edge Room

Session followed by Dessert Reception at Harbor's Edge Room

Thursday  
May 7

7:30 to 8:15 a.m.    Continental Breakfast  
8:30 to 10:00 a.m.   Session 1: Concurrent Presentations

10:00 to 10:15 a.m. Break  
10:15 to 11:45 a.m. Session 2: Concurrent Presentations  
12:00 to 1:00 p.m. Lunch  
*John Schmitt Award Presentation (Best Graduate Student Paper)*  
Harbor's Edge Room

1:15 to 2:45 p.m. Session 3: Presentations  
2:45 to 3:00 p.m. Break  
3:00 to 4:00 p.m. Keynote  
*Dr. Beth Harry, University of Miami*  
Harbor's Edge Room

4:00 to 5:00 p.m. Session 4: Poster Presentation Session  
(Immediately following the Keynote Address)  
Harbor's Edge Room

5:30 to 7:00 p.m. NEERO Gala  
Harbor's Edge Room

Friday  
May 8

7:30 to 8:15 a.m. Continental Breakfast  
8:30 to 10:00 a.m. Session 5: Concurrent Presentations  
10:00 to 10:15 a.m. Break  
10:15 to 11:45 a.m. Session 6: Concurrent Presentations

9:00 to 10:00 a.m. Workshop  
Educational Journal Publishing: An Editor's Perspective  
Ana M. Martínez Alemán, Boston College  
Gardner Room

9:00 to 12:00 Noon Workshop  
Introduction to In-Depth Interviewing as a Method of Qualitative  
Research  
Irv Seidman, University of Massachusetts, Amherst  
Lear Room

## **Conference Workshops**

### **Wednesday, May 6**

12:00 to 2:00 pm

Location: Gardner Room

*Youth Technology Practices: New Literacies and Emergent Learning Designs*

Presenters: Donna DeGennaro, University of Massachusetts, Boston

Dana Wilber, University of Massachusetts, Boston

2:15 pm to 4:15 pm

Location: Lear Room

*Conducting Research Involving Human Subjects and Navigating the Institutional Review Board (IRB) Process*

Presenter: Julie Simpson, University of New Hampshire

### **Friday, May 8**

9:00 to 10:00 am

Location: Gardner Room

*Educational Journal Publishing: An Editor's Perspective*

Presenter: Ana M. Martínez Alemán, Boston College

9:00 – 12:00 pm

Location: Lear Room

*Introduction to In-Depth Interviewing as a Method of Qualitative Research*

Presenter: Irv Seidman, University of Massachusetts, Amherst

**Wednesday, May 6**  
7:00 pm to 9:00 pm  
Opening Session  
Harbor's Edge Room

Sara Young,  
University of Massachusetts, Amherst  
Rubovits Award

Best 2008 Paper Presentation

“Becoming Allies: Privilege, Discourse, and Social Change”

Dessert and Coffee to Follow

## SESSION 1

1.1	Teaching and Learning Issues
Time:	Thursday, May 7, 8:30 - 10:00 AM
Place:	Prescott
Type:	Roundtable

### **Roundtable #1:**

White Teacher, White School, White State: Teacher Beliefs about the Education of Minority Students in Rural Maine

Heather L. Ball, University of Maine\*

Why do teachers choose to teach, or not to teach, in urban schools?

Yong Yu, Indiana University of Pennsylvania \*

George Bieger, Indiana University of Pennsylvania

Are Democratic Principles and Social Justice Values Evident in Sarajevo's Educational System?

Peter McDermott, The Sage Colleges \*

Brian K. Lanahan, The Sage Colleges

CHAIR/DISCUSSANT: Kelly Demers, Boston College

### **Roundtable #2:**

The Impact of Implementing a Social Curriculum in an Elementary Classroom: Its' Effects on the School's Culture and Student Achievement

An Evaluation of Appreciative Inquiry as Organizational Development for an alternative school

Michael Young, University of New Hampshire \*

Minority student education and middle class education: A study of an urban-suburban interdistrict transfer program

CHAIR/DISCUSSANT: Julie Simpson, University of New Hampshire \*

### **Roundtable #3:**

Putting words on paper: Elementary Students' Perceptions of Writing

Danelle Conner, Indiana University of Pennsylvania \*

Visual Approaches to Vocabulary Instruction: Teacher and Learner Perceptions

Dana L. Delker, Indiana University of Pennsylvania \*

Conversations About Reading: An Evaluation of the Metacognitive Processes Middle School Students Utilize While Reading

CHAIR/DISCUSSANT: Frank Corbett, Jr, Indiana University of Pennsylvania \*

Roundtable #4:

What Highly Efficacious Student Teachers Do

Donna M. Painter, Indiana University of Pennsylvania \*

The Important Role of Autobiographical Experience in Teacher Preparation and Development

Tara Nappi, University of Massachusetts \*

Understanding Culture in Context: A case study of prospective teachers' field experiences

Deborah McMakin, University of Massachusetts Lowell \*

CHAIR/DISCUSSANT: Cara McDermott-Fasy, Boston College \*

Roundtable #5:

State-Mandated History and Social Science Curriculum Framework and the Perceptions of Teachers: A Qualitative Study

Christopher Martell, Boston University \*

How Can Universities Measure Ethical Reasoning?

Steven E. Stemler, Wesleyan University \*

Eyal Bar-David, Wesleyan University \*

How do adult foreign language learners experience the opportunities presented by computer games as a self-study tool?

Li Feng, University of Massachusetts Lowell \*

CHAIR/DISCUSSANT: Phyllis Gimbel, Bridgewater State College \*

1.2	Student Recruitment, Retention & Achievement
Time:	Thursday, May 7, 8:30 - 10:00 AM
Place:	Wentworth Room
Type:	Paper Session

Self-Efficacy and Post-Secondary First-Time Student Achievement

Stephen P. Becker, Pine Manor College\*

Robert K. Gable, Johnson & Wales University \*

Chasing Dreams: Facilitating Successful Transfer in a Community College/University Partnership

Kelli Jo Kerry-Moran, Indiana University of Pennsylvania \*

How Does Student Perceived Social Support Offered by Formal/Informal Mentoring Influence the Academic Success of First Year African American Male Students?

CHAIR/DISCUSSANT: Peter Simpson, Johnson & Wales University

1.3	Teaching and Learning in Various Context
Time:	Thursday, May 7, 8:30 - 10:00 AM
Place:	Lear Room
Type:	Paper Session

Teach for America and a Theory of Social Justice: Distribution, Recognition, and the Politics of Pluralism

Educators' Gendered Experiences of a Catholic, Single-Sex Teaching Environment  
Kristin A. Pesola-McEachern, Boston College\*

The Invisible Work of the Teacher Educator  
Janet D. Johnson, Rhode Island College \*  
Jennifer S. Cook, Rhode Island College

Variability among Urban Youth: A Cognitive Case Study  
David Kritt, College of Staten Island \*

CHAIR/DISCUSSANT: Jayson Seaman, University of New Hampshire \*

1.4	Research and Educational Evaluation
Time:	Thursday, May 7, 8:30 - 10:00 AM
Place:	Gardner Room
Type:	Paper Session

Unifying Views of Educational Research and Educational Evaluation

Utilization-Focused Evaluations: A Follow-Up Study using a Meta-Evaluation Approach  
Jessica Brown, Boston College \*  
Kyle DeMeo, Strategies for Children

Creation and Initial Validation of a Non-Intellective Measure of Academic Success among College Students  
William Samuels, The City University of New York \*  
Ada Woo, National Council of State Boards of Nursing (NCSBN)

Using the Rasch Model to Validate a Comprehensive School Reform Rubric  
Susan Gracia, Rhode Island College \*

CHAIR/DISCUSSANT: Jennifer Dunn, Measured Progress

1.5	Technology in Teaching
Time:	Thursday, May 7, 8:30 - 10:00 AM
Place:	Thaxter Room
Type:	Paper Session

Students, Laptops, and School Achievement: Identity Construction in One-to-One Classrooms

Teaching Simple Machines to Fifth Graders through LEGOTM Engineering-Design Curriculum

Ismail Marulcu, Boston College \*

Michael Barnett, Boston College

Going High Tech Under High Surveillance: integrating technology into the high school English classroom amidst a culture of zero tolerance

Tricia M. Kress, University of Massachusetts Boston \*

Collaborative Problem Solving in Synchronous Computer Mediated Communication

Environments: Exploring the Evolution of Chat as a Speech Genre

Claire E. Hamilton, University of Massachusetts, Amherst

Alexandra Deschamps, University of Massachusetts, Amherst \*

Allessio Danielle, University of Massachusetts, Amherst

Tony Sindelar, University of Massachusetts, Amherst

German Vargas, University of Massachusetts, Amherst \*

Nicholas Wilson, University of Massachusetts, Amherst

Yan Zhu, University of Massachusetts, Amherst

CHAIR/DISCUSSANT: Therese Roberts, University of Massachusetts, Amherst

1.6	Leadership in Various Contexts
Time:	Thursday, May 7, 8:30 - 10:00 AM
Place:	Woodbury Room
Type:	Paper Session

Exploring Teacher Leadership Through Teacher Spheres of Influence

Sarah Mackenzie, University of Maine \*

Janet Fairman, University of Maine \*

Transformational leadership: an exploratory study

Situated in a Community of Practice: Leadership Preparation Practices to Support Leadership in K-8 Schools

Donna Braun, Rhode Island Instructional Leadership Academy \*

Robert Gable, Johnson & Wales University \*

Stacey Kite, Johnson & Wales University

Global Warming and Climate Change: A Challenge for Educators in the Age of the Sustainability Revolution

Irina Trubetskova, University of New Hampshire \*

CHAIR/DISCUSSANT: Margaret Berci, College of Staten Island CUNY \*

1.7	Higher Education Perspectives
Time:	Thursday, May 7, 8:30 - 10:00 AM
Place:	Warner Room
Type:	Paper Session

Gender Disparity in Demographic, Employment, and Institutional Characteristics in the Asian/Pacific Islander Postsecondary Faculty: Evidence from NSOPF:04

Parveen Ali, Indiana University of Pennsylvania \*

ISLLC/ELCC Standards Implementation: Do Education Administration Faculty Practice What They Preach?

Crystal Machado, Indiana University of Pennsylvania \*

Elizabeth Kalu, Indiana University of Pennsylvania \*

Evaluating the Effectiveness of an Upward Bound Program: Staff Perspectives

John Maddaus, University of Maine \*

"You have no alibi in existence": Dialog as Resistance to State Standards

Stephen Sadlier, University of Massachusetts, Amherst \*

Barbara Madeloni, University of Massachusetts \*

CHAIR/DISCUSSANT: Todd DeMitchell, University of New Hampshire

**SESSION 2**

10:15 - 11:45 A.M  
Thursday, May 7  
Concurrent Presentations

12:00 noon – 1:00 PM  
Thursday, May 7  
Langdon  
  
Lunch Meeting  
Schmitt Award Presentation  
(Best Graduate Student Paper Winner)

## SESSION 2

2.1	Perspectives in K-12 and Higher Education Settings
Time:	Thursday, May 7, 10:15 - 11:45 AM
Place:	Prescott
Type:	Roundtables

### Roundtable #1:

Beginning teachers? Perceptions on learning and teaching history.

Christopher Martell, Boston University \*

Scott Heald, Boston University \*

Anthony J. Zavagnin, Boston University \*

Validating a Metacognitive Knowledge Model for ESL/EFL Reading Teachers

Wei Xu, University of Massachusetts at Lowell \*

Revising and Rewriting Roles: Exploring the Challenges of Peer Tutors in One High School Student-Staffed Writing Center

Cindy Dean, University of Maine \*

Technology Integration in the Secondary Social Studies Classroom

CHAIR/DISCUSSANT: Michaela Colombo, University of Massachusetts, Lowell

### Roundtable #2:

How Can Universities Assess the Development of Intercultural Literacy?

Alex Hartley, Wesleyan University

Steven Stemler, Wesleyan University \*

Beliefs and Attitudes about Information Literacy in Higher Education

Portia Diaz, Indiana University of Pennsylvania\*

Hearts in a Time Capsule: What the educational autobiographies of first-generation, college-bound teens teaches educators about educational practice and policy in literacy education.

CHAIR/DISCUSSANT: John Maddaus, University of Maine \*

### Roundtable #3:

Creating Learning Environments that afford Social Participation

Science and Language in the Elementary School Classroom

Stephen Ribisi, University of Massachusetts, Boston \*

Peer Feedback for Graduate Students: Is it Valuable?  
Dee Berlinghoff, Mount Saint Mary College \*

CHAIR/DISCUSSANT: Claire E. Hamilton, University of Massachusetts, Amherst

2.2	Dance Ten, Looks Three? The Wisdom Of Practice v Completing A College Degree
Time:	Thursday, May 7, 10:15 - 11:45 AM
Place:	Wentworth Room
Type:	Symposium

Dance Ten, Looks Three? The wisdom of practice v completing a college degree  
Jorgelina Abbate-Vaughn, University of Massachusetts Boston \*  
Paugh Patricia, University of Massachusetts Boston \*  
Brian Wright, University of Massachusetts Boston

The Impact of Teacher Behavior on Preschoolers' Social-emotional Development  
Lauren Ann Sonnabend, Wesleyan University \*

CHAIR/DISCUSSANT: Julia Zoino-Jeannetti, Framingham State College \*

2.3	Preparing Tomorrow's Teachers
Time:	Thursday, May 7, 10:15 - 11:45 AM
Place:	Lear Room
Type:	Paper Session

Practitioner research and preservice Teacher Education: moving toward inquiry as stance  
Kim Fries, University of New Hampshire \*

Reading to Learn, Loving to Read: Preservice Teachers in Book Talk to Become More Passionate Teachers of Reading  
Janine Bixler, Mount Saint Mary College \*  
Dee Berlinghoff, Mount Saint Mary College \*

I Think I Can: Self-efficacy Development in Urban Student Teachers  
Donna M. Painter, Indiana University of Pennsylvania \*  
Kelli Jo Kerry Moran, Indiana University of Pennsylvania \*  
Monte Tidwell, Indiana University of Pennsylvania

Preparing teachers for deliberative democracy  
Sarah M. Stitzlein, University of New Hampshire \*

CHAIR/DISCUSSANT: Kerri Ullucci, University of Massachusetts, Dartmouth \*

2.4	Issues In Special Education
Time:	Thursday, May 7, 10:15 - 11:45 AM
Place:	Gardner Room
Type:	Paper Session

University and Community Partnerships: Benefits to Families of Children with Disabilities and Community Organizations

Lusa Lo, University of Massachusetts Boston \*

Teachers' Perceptions of Asian American Students and Factors Contributing to Special Education Referrals

Family-School Partnerships in Special Education: A Narrative Study of Parental Experience  
Cara McDermott-Fasy, Boston College \*

Independent Educational Evaluations - IDEA 2004: It's a Testy Matter!

CHAIR/DISCUSSANT: Margaret Pierce, University of Massachusetts, Amherst

2.5	Technology and Teaching
Time:	Thursday, May 7, 10:15 - 11:45 AM
Place:	Thaxter Room
Type:	Paper Session

Examination of generational differences on computer-based & paper-based tests

Alexander Wind, State University of New York at Albany \*

Alexander Ma, Excelsior College

Examination of Facilitator Effectiveness Attributes on Future Online Professional Development Enrollment

Kara Smith, Boston College

Lauren Chapman, Boston College

Joseph Pedulla, Boston College \*

Learning with laptops: An empirical investigation of educational practices in Boston's Public Schools first middle school laptop initiative

Adjunct Visual Aids and the Learning of Scientific-Technical Content

CHAIR/DISCUSSANT: Jennifer Cook, Rhode Island College

2.6	Improving Teaching Practice And Assessment
Time:	Thursday, May 7, 10:15 - 11:45 AM
Place:	Woodbury Room
Type:	Paper Session

Developing a Teaching Practice Under the Auspice of Mathematics Reform: Issues and Challenges

Mary Grasseti, University of Massachusetts Amherst \*

Connecting US to Strengthen K-5 Mathematics Content and Pedagogy: A University/School Partnership

Susan J. Hillman, University of New England \*

Using Evidence to Develop and Expand the Massachusetts Pre-Service Performance Assessment

Sarah Enterline, Boston College \*

Fran Loftus, Boston College

Lisa D'Souza, Boston College

Joan Barnatt, Boston College

A Discussion of the Problems with Problem-Based Learning

Margaret Berci, College of Staten Island CUNY \*

CHAIR/DISCUSSANT: William El Samuels, College of Staten Island- CUNY \*

2.7	Engaging Scholarship: Pedagogy and Research in a Doctoral Program in Educational Leadership
Time:	Thursday, May 7, 10:15 - 11:45 AM
Place:	Warner Room
Type:	Symposium Session

Engaging Scholarship: Pedagogy and Research in a Doctoral Program in Educational Leadership

Karen I. Case, University of Hartford

K. Darcy Hohenthal, University of Hartford

Tatum Krause, University of Hartford \*

Suzanne D'Annolfo, University of Hartford

CHAIR/DISCUSSANT: Sarah Mackenzie, University of Maine \*

### SESSION 3

3.1	Issues In Teaching And Learning
Time:	Thursday, May 7, 1:15 – 2:45 PM
Place:	Wentworth Room
Type:	Paper Session

Reflecting On The Urban Ecology Curriculum: Engaging Students and Teachers in Dialogue and Hermeneutics with Technology

Diane Silva Pimentel, Boston College \*

Katherine McNeill, Boston College

Teaching for Transfer: Native language instruction in a structured English immersion classroom

Patrick Proctor, Boston College

Claudia Vargas, Boston College \*

“Does RTI Help First Graders at Risk for Reading Problems?”

CHAIR/DISCUSSANT: Sarah Mackenzie, University of Maine \*

3.2	Perspectives From High School And Adult Education
Time:	Thursday, May 7, 1:15 – 2:45 PM
Place:	Lear Room
Type:	Paper Session

A Sample of High School Student Scores on the Force Concept Inventory

Role of Feedback in Complex Social Systems: Perceptions of High School Principals About Feedback That Allows Them to Attain Goals and Performance Standards

Daniel Rouse, University of Massachusetts, Lowell \*

Women’s Learning

Julie Zoino-Jeannetti, Framingham State College \*

CHAIR/DISCUSSANT: Eduardo Vianna, City University of New York \*

3.3	Moving Beyond Whiteness: The Meaning of Racial Consciousness
Time:	Thursday, May 7, 1.15 – 2.45 PM
Place:	Gardner Room
Type:	Symposium

Moving Beyond Whiteness: The Meaning of Racial Consciousness  
 Kelly Demers, Boston College  
 Rachel Johnson, University of New Hampshire \*  
 Kathy McDonough, University of Massachusetts, Amherst \*

CHAIR/DISCUSSANT: Patricia Paugh, University of Massachusetts, Boston \*

3.4	Achieving And Overcoming Barriers
Time:	Thursday, May 7, 1:45 – 3:15 PM
Place:	Thaxter Room
Type:	Paper Session

Academic Achievement and Policy Effectiveness: Educators' Perceptions of African American

You Mean if Someone Had Cared?: Relational Factors and Conditions Involved in Teens'  
 Decisions to Graduate with a GED Certificate  
 Cheryl Saliwanchik-Brown, University of Maine \*

Exploring Links between Mind, Brain, and Education  
 Signia Warner, Westfield State College \*  
 Lolly Templeton, Westfield State College

CHAIR/DISCUSSANT: Lusa Lo, University of Massachusetts Boston \*

3.5	Returning to Plato's Cave: How once inspired and naïve educators overcame the psychic gridlock of the American education system
Time:	Thursday, May 7, 1:15 – 2:45 PM
Place:	Woodbury Room
Type:	Symposium Session

Returning to Plato's Cave: How once inspired and naïve educators overcame the psychic gridlock of the American education system

Jacob Werblow, Central Connecticut State University \*

Barbara Clark, Central Connecticut State University

Joss French, Central Connecticut State University \*

Kurt Love, Central Connecticut State University

CHAIR/DISCUSSANT: Jacob Werblow, Central Connecticut State University \*

3.6	Technology In Education
Time:	Thursday, May 7, 1:15 – 2:45 PM
Place:	Warner Room
Type:	Paper Session

The Impact of Patient Rounds on the Professional Practiced of ED Nurses as Evidenced by Patient Satisfaction

Robin L. Guisti, University of Hartford \*

Margaret Mancuso, University of Hartford \*

Encouraging Practitioner Doctoral Students in Education to Present at AERA

Mark Fenster, University of Massachusetts Lowell\*

Supply and Demand: Nurses and an Aging Population

Leslie J. Harris, University of Hartford \*

CHAIR/DISCUSSANT: Rebecca Rockey, Slippery Rock University \*

3.7	Operationalizing Validity: Challenges and issues encountered in large scale assessments
Time:	Thursday, May 7, 1:15 – 2:45 PM
Place:	John Paul Jones Room
Type:	Symposium Session

Operationalizing Validity: Challenges and issues encountered in large scale assessments

CHAIR/DISCUSSANT: Lisa Keller, University of Massachusetts, Amherst

**SESSION 4**

3:00 - 4:00 PM  
Thursday, May 7  
Harbor's Edge Room

Keynote Address

By

Dr. Beth Harry  
University of Miami

“Why Are So Many Students of Color in Special Education Classes and What Can We Do about It?”

	<b>Poster Session 4</b>
Time:	Thursday, May 7, 4:00 – 5:00 PM
Place:	Harbor's Edge Room
	(immediately following the Keynote Address)

Data-Based School Improvement Planning: Test Scores Are Not Enough

Multicultural Music Education: Building an Appreciative Audience  
Marguerite K Weidknecht, University of Massachusetts Lowell \*

Adolescent girls' negotiations of embodied knowing, the female body, and literacy  
Christine Woodcock, Southern New Hampshire University \*

Racism & the Looking Glass Self: Education and the Internalization of Low Expectations

The difference between gender and gender orientation in predicting motivation, achievement goal orientation, and self-perceived competence  
Judy H. Tang, University of New Hampshire \*

The Five Wise Men: African-American males using Urban Critical Literacy to Achieve School Success in an Urban Pilot School in the U.S.

University Students' Social Ties and Social Distance with a Particular Focus on Racial and Ethnic Diversity

Exposure to Dialect Awareness Training in Teacher Education Programs

An Observational Study of Pre-Service Teachers' Classroom Management Strategies  
Rebecca Rockey, Slippery Rock University\*

How Can Universities Help Provide a Positive Impact on Teacher Retention

Susan Kiger, Indiana State University  
Della Thacker, Indiana State University  
Larry S. Tinnerman, Indiana State University \*  
Susan Kiger, Indiana State University  
Della Thacker, Indiana State University

The Correlation between Nursery Rhyme Awareness and Phonological Awareness

Laurie J. Harper, University of Rhode Island \*  
Melissa Botelho, University of Rhode Island  
Rory Solomon, University of Rhode Island \*

Tribal Rule: Undergraduate Perceptions of Business Etiquette in Internships

Annette Rogers, University of Hartford\*

The School Experiences and Achievement of an NCLB Student Cohort: A Connecticut Perspective  
Norma Sinclair, Connecticut State Department of Education \*

5:30 – 7:00 PM  
Thursday, May 7  
Harbor's Edge Room

The NEERO Board of Directors invites you to our annual  
**NEERO GALA**

## SESSION 5

5.1	Perspectives Of Teaching And Learning
Time:	Friday, May 8, 8:30 – 10:00 AM
Place:	Harbor's Edge Room
Type:	Roundtables

### Roundtable #1:

Translating Theory into Practice: How Are Novice Art Teachers Implementing Praxis?

Kathy Miraglia, University of Massachusetts, Dartmouth \*

Cathy Smilan, University of Massachusetts, Dartmouth \*

Personal History and Present Practice: Influences On Arts Integration in Elementary School Classrooms

Jana Silver, Hampshire College \*

Evaluating a Job-Embedded Professional Development Program That Uses Art to Teach Incarcerated Youth

Jeffrey W. Eiseman, University of Massachusetts, Amherst \*

CHAIR/DISCUSSANT: Deb Patterson, Western New England College \*

### Roundtable #2:

Establishing Habits of Collaboration and Reflection: A Case Study of the New Mathematics Teachers Support Network

Shannon Bryant, University of Massachusetts, Amherst \*

A Qualitative Review of Initial Participants in Professional Development School: An Opportunity to Evaluate and Improve the Partnership

Teacher Interns, Developing the Characteristics of Effective Teachers through Urban Experiences in Professional Development Schools

Stacie M. Wolbert, Indiana University of Pennsylvania\*

Gwyneth A. Price, Edinboro University of Pennsylvania \*

CHAIR/DISCUSSANT: Larry Tinnerman, Indiana State University \*

### Roundtable #3:

To What Degree Do College Professors Utilize Differentiated Instruction

Rebecca Rockey, Slippery Rock University\*

Lisa Tong, Edinboro University

Creative Drama in the Higher Education Classroom and Across Disciplines: A Review of the Literature

Kelli Jo Kerry-Moran, Indiana University of Pennsylvania \*

Using Weblogs for Literature Response with Elementary Students

CHAIR/DISCUSSANT: Jeremy F. Price, Boston College \*

Roundtable #4:

A Degree of Debt

Whitney M. Wesley, Indiana University of Pennsylvania

Frank Corbett, Jr, Indiana University of Pennsylvania \*

Empowering Relationships: Mentoring in the Undergraduate Setting

Dorothy Gracey, Indiana University of Pennsylvania\*

JoAnn Thistlethwaite, Indiana University of Pennsylvania \*

Developing Online Support Systems for Student Teachers

Donna M. Painter, Indiana University of Pennsylvania \*

Dual Enrollment in Rural Pennsylvania: A Descriptive Quantitative Study

Mary Beth Partridge, Indiana University of Pennsylvania \*

CHAIR/DISCUSSANT: Frank Corbett, Jr, Indiana University of Pennsylvania \*

Roundtable #5:

Math Homework: Help or Hinderance

Meghan Elwood-Hubacz, University of New Hampshire \*

Helping Students At Risk Develop Computational Fluency

Anne Goodrow, Rhode Island College \*

Lisa Owen, Rhode Island College \*

Using Robotics to teach fundamental algebra

Stephen H. Whitehead, Indiana University of Pennsylvania \*

CHAIR/DISCUSSANT: Susan Hillman, University of New England \*

5.2	Topics in Item Response Theory and Educational Measurement I: Applications of Item Response Theory to Large-Scale Assessments
Time:	Friday, May 8, 8.30 – 10.00 AM
Place:	Webster's Room
Type:	Symposium

Topics in Item Response Theory and Educational Measurement I: Applications of Item Response Theory to Large-Scale Assessments

Larry Ludlow, Boston College \*

CHAIR/DISCUSSANT: Larry Ludlow, Boston College

5.3	Thinking Through Ethnography
Time:	Friday, May 8, 8.30 – 10.00 AM
Place:	Thaxter Room
Type:	Symposium

### Thinking Through Ethnography

Tom Schram, University of New Hampshire \*  
 JoAnne Malloy, University of New Hampshire  
 Anita Charles, University of New Hampshire \*  
 Megan Paddack, University of New Hampshire \*  
 Erica Blatt, University of New Hampshire \*

CHAIR/DISCUSSANT: Tom Schram, University of New Hampshire\*

5.4	Teacher Induction, Mentoring And Professional Development
Time:	Friday, May 8, 8.30 – 10.00 AM
Place:	Wentworth Room
Type:	Paper Session

### A professional development program and its relationship with teacher effectiveness

Nelly Tournaki, College of Staten Island/CUNY  
 Irina Lyublinskaya, College of Staten Island/CUNY \*  
 Brian Carolan, College of Staten Island/CUNY

### Collaborative Teacher Induction: Inquiry-Oriented Professional Development for NEW Teachers

Linda Clark, Harvard University \*  
 Paige M. Bray, The Teachers' Loft \*

### Expectations for Career and Social Support by Mentors and Mentees Participating in Formal Mentoring Programs in Rhode Island

Monique Jacob Johnson & Wales University\*  
 Robert Gable, Johnson & Wales University \*

### How Effective is School-Wide Positive Behavior Support in Preventing Problem Behaviors?

James Cressey, University of Massachusetts Amherst \*  
 Benjamin Solomon, University of Massachusetts Amherst \*  
 Suzy Klein, University of Massachusetts Amherst \*  
 Sarah Peller, University of Massachusetts Amherst  
 John Hintze, University of Massachusetts Amherst

CHAIR/DISCUSSANT: Kim Fries, University of New Hampshire \*

5.5	Developing And Learning: Preschool And Beyond
Time:	Friday, May 8, 8:30 – 10:00 AM
Place:	Warner Room
Type:	Paper Session

Bridging the gap in early literacy interventions: The involvement of teachers in re-designing and implementing the Dialogic Reading Program and its effects on early literacy outcomes among preschool children from low-income communities.  
Rachel Boit, University of Massachusetts \*

Finding Common Ground: Metacognition in Literacy and Mathematics Learning  
James A. Preston, Slippery Rock University of Pennsylvania \*  
Cinda Findlan, Slippery Rock University of Pennsylvania \*

Imagining Otherwise through Strategic Alignment: The Grammar of a Multicultural Pedagogic Repertoire

CHAIR/ DISCUSSANT: Alice Torres, University of Hartford \*

5.6	Books, Budget Cuts, and Blancos: Latino/a Youth Researchers Respond to Structural Inequality
Time:	Friday, May 8, 8.30 – 10.00 AM
Place:	Woodbury Room
Type:	Symposium

Books, Budget Cuts, and Blancos: Latino/a Youth Researchers Respond to Structural Inequality  
Jason G. Irizarry, University of Connecticut \*  
Cassandra Avilez, Windham High School  
Caridad Booker, Windham High School  
Janyl Mendez, Windham High School  
Alejandro Quiroz, Windham High School  
Luis Reynaldo Rosario, Windham High School  
Tatiana Ruiz, Windham High School  
Neyveli Zavala, Windham High School  
Aja E. LaDuke, University of Connecticut \*  
Susana Ulloa, University of Connecticut

CHAIR/ DISCUSSANT: Jason G. Irizarry, University of Connecticut \*

## SESSION 6

6.1	Topics in Item Response Theory and Educational Measurement II: Differential Item Functioning
Time:	Friday, May 8 <sup>th</sup> , 10.15 – 11.45 AM
Place:	Webster's Room
Type:	Symposium

Topics in Item Response Theory and Educational Measurement II: Differential Item Functioning  
Larry Ludlow, Boston College \*

CHAIR/DISCUSSANT: Larry Ludlow, Boston College

6.2	Teaching In Culturally And Linguistically Diverse Settings
Time:	Friday, May 8, 10.15 – 11.45 AM
Place:	Thaxter Room
Type:	Paper Session

Examining Two Delivery Models of a Teacher Professional Development Program for Effective Instruction for English Language Learners: Perceptions and Experiences of Trainers and Teachers  
Kathryn Sallis, Boston College \*  
Anne Homza, Boston College

Teacher Relationships with Research in ESL Classrooms

Grounding CRT in Participatory Inquiry: Raising Educators' Race Consciousness and Co-Constructing Antiracist Pedagogy  
Evelyn Young, Boston College \*

Knowing We Are White: Narrative as Critical Praxis  
Kerri Ullucci, University of Massachusetts, Dartmouth \*

CHAIR/DISCUSSANT: Sarah Stitzlein, University of New Hampshire \*

6.3	Learning, Technology And Assessment Issues
Time:	Friday, May 8, 10.15 – 11.45 AM
Place:	Wentworth Room
Type:	Paper Session

Reflecting On The Urban Ecology Curriculum: Engaging Students and Teachers in Dialogue and Hermeneutics with Technology  
 Jeremy F. Price, Boston College \*  
 Katherine L. McNeill, Boston College

Under scrutiny: State, SPA, and NCATE considerations in graduate assessment  
 Susan Gracia, Rhode Island College \*  
 Monica G. Darcy, Rhode Island College  
 Marie A. Lynch, Rhode Island College \*

The Relationship Between Computer Use and Standardized Test Scores: Does Gender Play a Role?  
 Rachel Kay, Boston College \*

The Graduate Research Assistantship: A New Model for Master's Degree Education  
 Phyllis Gimbel, Bridgewater State College \*  
 Ryan M. Cole, Randolph High School

CHAIR/DISCUSSANT: Portia Diaz, Indiana University of Pennsylvania \*

6.4	Research, Leadership And Policy
Time:	Friday, May 8, 10.15 – 11.45 AM
Place:	Warner Room
Type:	Paper Session

School Readiness: District Use of State Policy Tools  
 Alice Torres, University of Hartford \*

The Eight-Year Study and Charter Legitimacy: A Historical and Institutional Lens on Educational Innovation  
 Matthew Welch, Boston College\*

A Method for Evaluating District Performance  
 Peter Simpson, Johnson & Wales University  
 Stacey L. Kite, Johnson & Wales University  
 Robert Gable, Johnson & Wales University \*

Assessment of General Education of Doctoral Students Matriculating in an Educational Leadership Program in a Southern New England University

Martin Sivula, Johnson & Wales University\*  
 Thomas Sepe, Community College of Rhode Island

CHAIR/DISCUSSANT: Robert Fried, Upper Valley Educators Institute

6.5	Making Math Instruction Count: In Search of Evidence-Based Practices for Students with Math Difficulties
Time:	Friday, May 8, 10.15 – 11.45 AM
Place:	Woodbury Room
Type:	Symposium

Making Math Instruction Count: In Search of Evidence-Based Practices for Students with Math Difficulties

Margaret E. Pierce, University of Massachusetts Amherst  
 Melena Fontaine, University of Massachusetts Amherst  
 Jessica Fede, University of Massachusetts Amherst  
 James Cressey, University of Massachusetts Amherst \*  
 Alicia Gram, University of Massachusetts Amherst \*

CHAIR/DISCUSSANT: Margaret E. Pierce, University of Massachusetts Amherst

6.6	Culturally Responsive Approaches to Non-Traditional Education for Non-Traditional Students: Applications of Sociocultural Theory
Time:	Friday, May 8, 10.15 – 11.45 AM
Place:	John Paul Jones Room
Type:	Symposium

Culturally Responsive Approaches to Non-Traditional Education for Non-Traditional Students: Applications of Sociocultural Theory

Kim Rybacki, City University of New York \*  
 Lara Beaty, City University of New York \*  
 Dusana Podlucka, City University of New York  
 Eduardo Vianna, City University of New York \*

CHAIR/DISCUSSANT: David Krittr, College of Staten Island \*

**Room Assignments - Wednesday**

Room	11:00 - 5:00 PM	12:00 NOON – 2:00 PM	2:15 – 4:15 PM	7:00 – 9:00 PM
Hotel Lobby	Registration			
Gardner Room		Workshop		
Lear Room			Workshop	
Harbor's Edge Room				Rubovits Award and Dessert Reception

**Room Assignments - Thursday**

Room	8:30 - 10:00 AM	10:15 - 11:45 AM	12:00 NOON – 1:00 PM	1:15 – 2:45 PM	3:00 – 5:00 PM	5:30 – 7:00 PM
Prescott	1.1	2.1				
Wentworth Room	1.2	2.2		3.1		
Lear Room	1.3	2.3		3.2		
Gardner Room	1.4	2.4		3.3		
Thaxter Room	1.5	2.5		3.4		
Woodbury Room	1.6	2.6		3.5		
Warner Room	1.7	2.7		3.6		
John Paul Jones Room				3.7		
Harbor's Edge Room			Luncheon Awards		Keynote Panel, Poster Session	NEERO Gala w/ Hors d'oeuvre

**Room Assignments - Friday**

Room	8:30 -10:00 AM	10:15 -11:45 AM	9:00 – 10:00 AM	9:00 – 12:00 Noon
Harbor's Edge Room	5.1			
Webster's Room	5.2	6.1		
Thaxter Room	5.3	6.2		
Wentworth Room	5.4	6.3		
Warner Room	5.5	6.4		
Woodbury Room	5.6	6.5		
John Paul Jones Room		6.6		
Gardner Room			Workshop	
Lear Room				Workshop

# Floor Plan

## LOBBY LEVEL

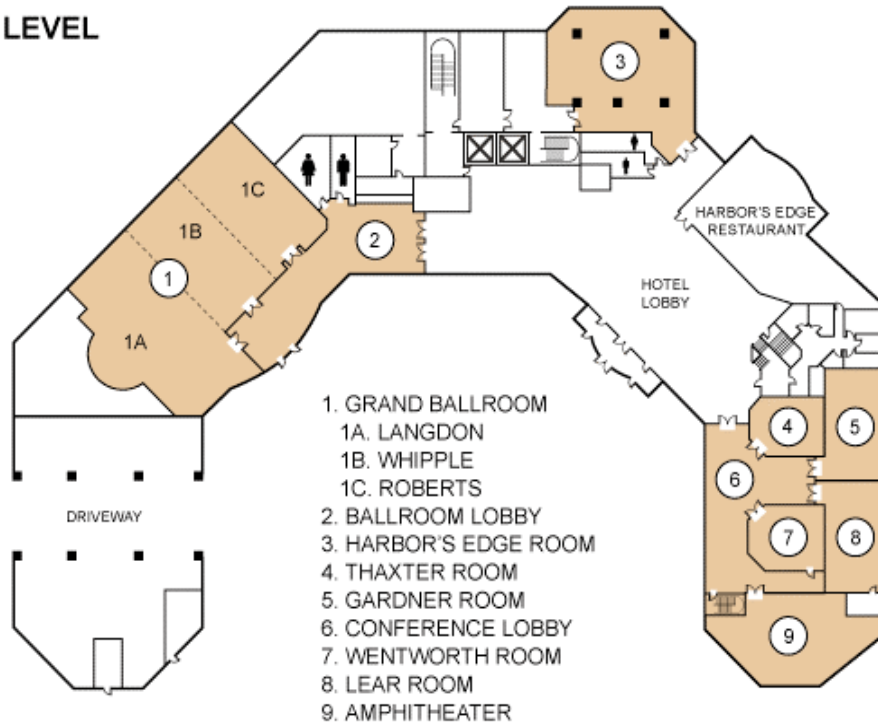

## MEZZANINE LEVEL

